



**RECORD OF TITLE  
UNDER LAND TRANSFER ACT 2017  
FREEHOLD  
Search Copy**



  
R. W. Muir  
Registrar-General  
of Land

**Identifier** **OT14B/689**  
**Land Registration District** **Otago**  
**Date Issued** 03 February 1992

**Prior References**

GN 351014 OIC 796160

---

**Estate** Fee Simple  
**Area** 9.1391 hectares more or less  
**Legal Description** Section 3-4 Survey Office Plan 23610

**Registered Owners**

Jennifer Anne Mitchell as to a 1/2 share  
Dale Clifford Mitchell as to a 1/2 share

---

**Interests**

Subject to Part IV A Conservation Act 1987  
Subject to Section 11 Crown Minerals Act 1991  
9944846.3 Mortgage to Southland Building Society - 28.1.2015 at 3:14 pm

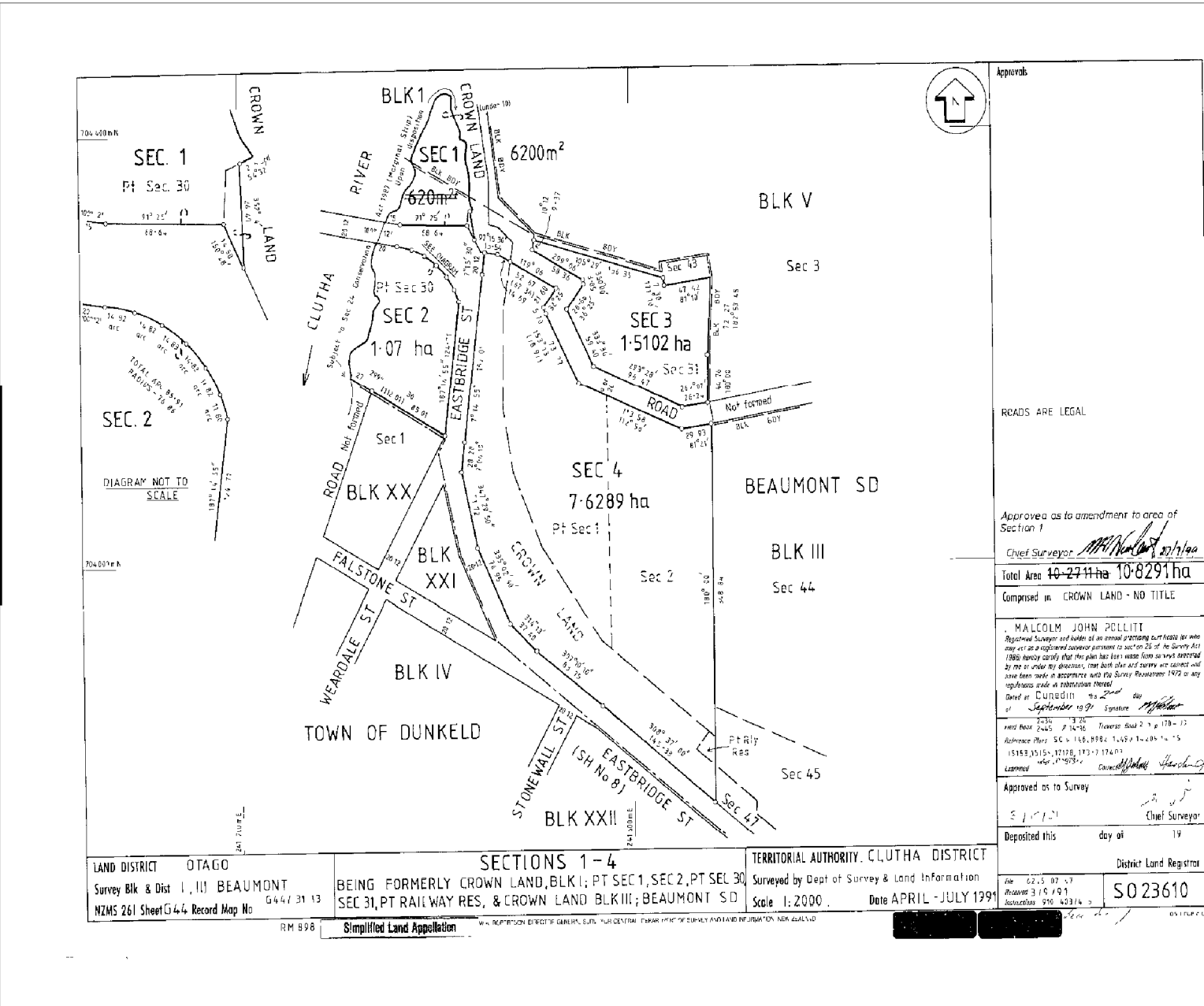

Approvals

ROADS ARE LEGAL

Approved as to amendment to area of Section 1

Chief Surveyor *[Signature]* 27/1/19

Total Area 10-2711 ha 10-8291 ha

Comprised in CROWN LAND - NO TITLE

MALCOLM JOHN POLLITT  
Registered Surveyor and holder of an annual practicing certificate for who may act as a registered surveyor pursuant to section 25 of the Survey Act 1980 hereby certifies that this plan has been made from an actual and correct survey or under my direction, and that all other surveys are correct and have been made in accordance with the Survey Regulations 1979 or any regulations made in substitution thereof.

Dated at Dunedin this 2nd day of September 1997 Signature *[Signature]*

1997 Book 2-30 p 320  
Crossed Book 2 p 170-171  
Reference Plans SC 146, 898, 1, 45, 1, 20, 1, 1, 5  
1515, 3515, 3212, 113-114, 11  
Learner *[Signature]* Chief Surveyor

Approved as to Survey  
21/1/19 Chief Surveyor

Deposited this day of 19

District Land Registrar

LAND DISTRICT OTAGO TERRITORIAL AUTHORITY CLUTHA DISTRICT  
 Survey Blk & Dist I, II, III BEAUMONT  
 NZMS 261 Sheet G44 Record Map No G44/3113  
 R.M. 898 Simplified Land Appellation

SECTIONS 1-4  
 BEING FORMERLY CROWN LAND, BLK I; PT SEC 1, SEC 2, PT SEC 30, SEC 31, PT RAILWAY RES. & CROWN LAND BLK III; BEAUMONT SD  
 Surveyed by Dept of Survey & Land Information  
 Scale 1:2000 Date APRIL - JULY 1997

File 623 82 17  
Process 319 91  
Succession 210 433/4  
SO 23610