

**General approach**

**Road area**

Each road entry to have a unique theme set around the road name, utilising stylised tree logos on signage\* and a combined native and exotic plant mix

**Reserve area**

Native plant theme with selection optimized for rapid canopy cover to suppress weeds while also having a range of heights, colours and planting arrangements for enjoyment and to provide an attractive backdrop to the local area

\* signage is external to this tender

Gully planted in lower shrubs and grasses with occasional clusters of larger trees, this will provide some intervisibility screening while also allowing sunlight into existing properties

Open, low-planted frontage leads the eye (and the walker) to the path network. Manuka Park beyond visible from the street as lighter space amidst low forest

Densely-planted surround of stormwater detention basin is tightly-coupled to entry park and Manuka Park above. Area to rear a continuation of the southern-boundary hoheria band with a small fuchsia glade



Aesthetic themes:  
Gully base and head mainly grasses and scattered trees, open and spacious and easily walked amongst in years to come. Using grasses in the base simplifies maintenance where broadleaf herbicides can be used to control dominant weeds

Having a more open grassy theme for gully bases reduces cost as grasses and tussocks are approx. two-thirds the price of broadleaves

Small cluster of red beeches nestled in the junction of the two gullies

Yellow line; area to east represents additional planting area outside initial planting funding allocation

Willow management area 7500m<sup>2</sup>, low-density tree planting into willow area, with staged willow removal as new trees grow

A semi-dense screen with occasional viewing gaps provides privacy from existing dwellings as well as a private but safely-overlooked walk. A porous band of hoheria with gully floor in sedges, shade-tolerant shrubs and naturally reoccurring ferns

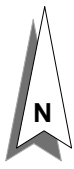

Underground service lines

Natural drainages

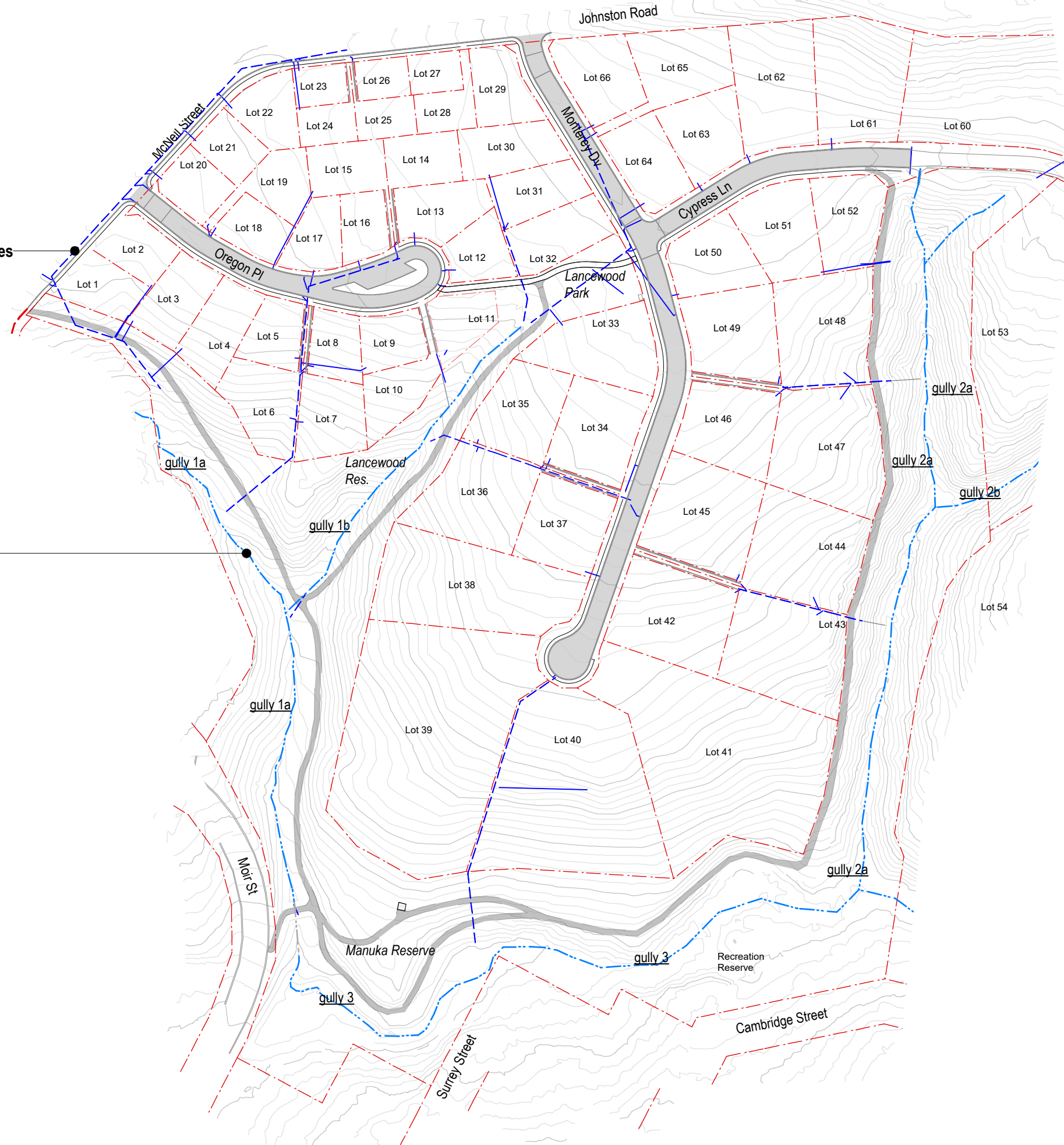



Cul de sacs - grassed in Year 1  
and planted in Year 3 pending driveway construction

1.3  
2017.09.20

drawing Overview  
location - Road planting  
client Balclutha  
Clutha District

scale 1:1250 @ A3  
www.growplan.co.nz  
nigel@growplan.co.nz  
027 214 7791

file 125.plantation.v  
• confirm services  
• do not scale off plan  
• verify all dimensions

**DRAFT** all rights reserved to  
growplan ltd  
dunedin.nz

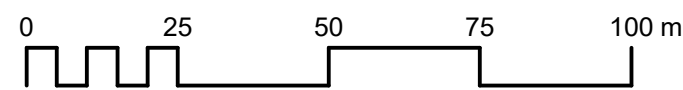





Service lines - underground

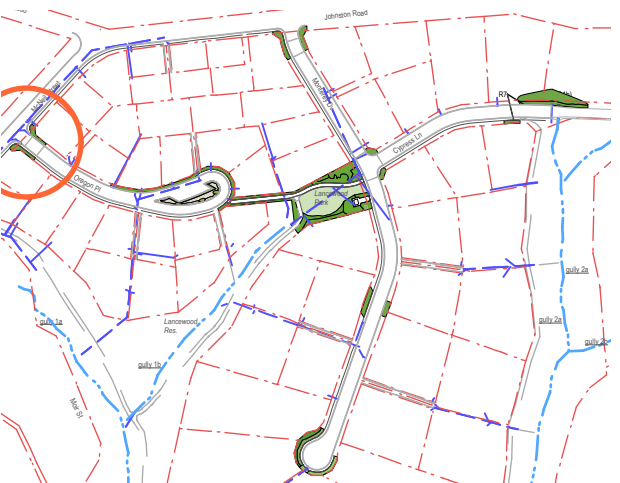

Site location

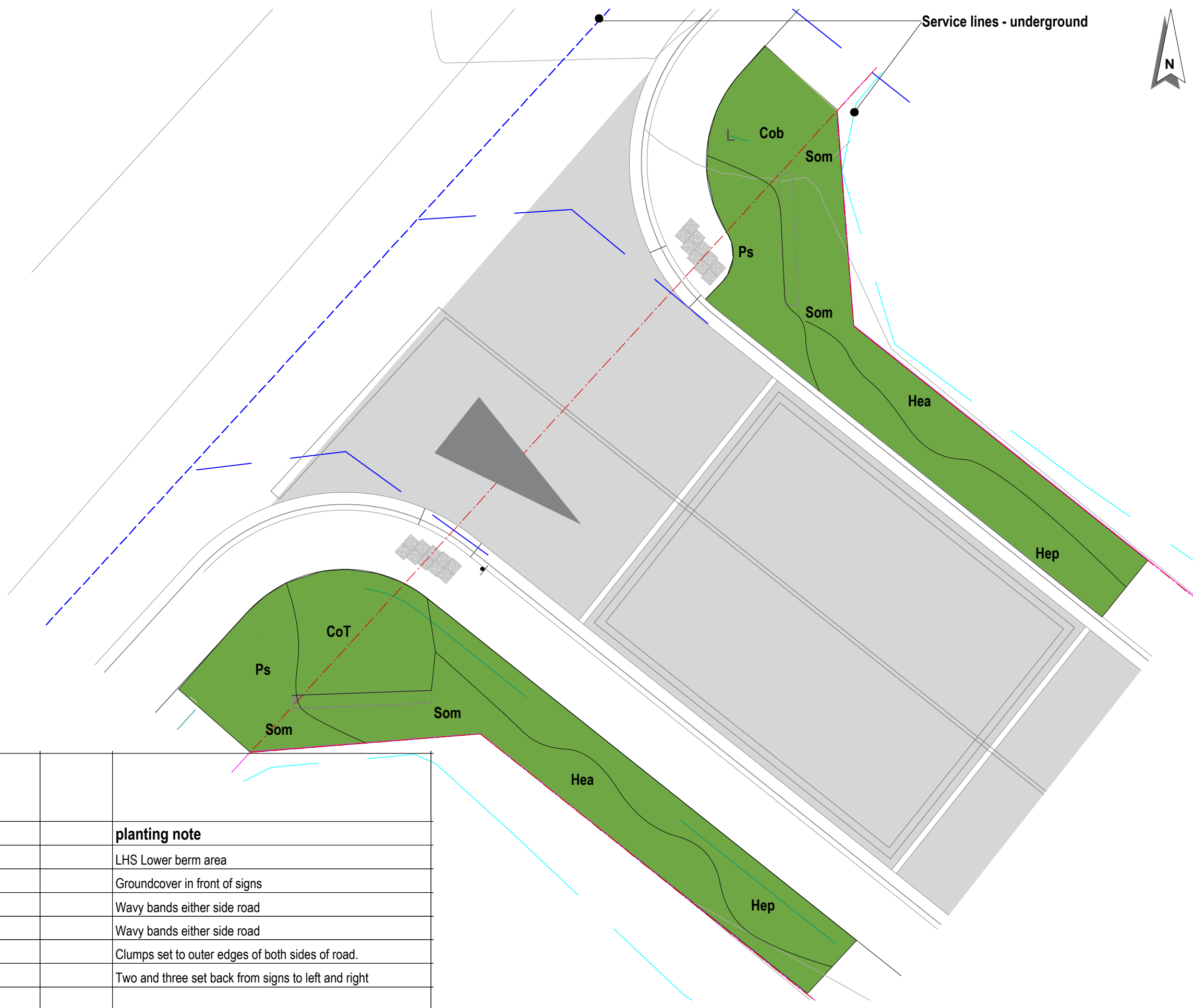

YR1 Road entry planting - Oregon Place					
botanical name	common name	code	units		planting note
Coprosma brunnea	coprosma	Cob	12		LHS Lower berm area
Coprosma Taiko	coprosma	CoT	16		Groundcover in front of signs
Hebe albicans	hebe	Hea	16		Wavy bands either side road
Hebe pagei prostrata	hebe	Hep	16		Wavy bands either side road
Pseudotsuga	Douglas fir - low form	Ps	8		Clumps set to outer edges of both sides of road.
Sophora microphylla	kowhai	Som	5		Two and three set back from signs to left and right
Totals			72		

Table 2.1c Oregon Place entry plants - planting area 87 m2

2.1b  
2017.09.20

drawing Street Planting Plan  
location Oregon Pl  
client Balclutha  
Clutha District

scale 1:100 @ A3  
www.growplan.co.nz  
nigel@growplan.co.nz  
027 214 7791

file 125.plantation.v  
• confirm services  
• do not scale off plan  
• verify all dimensions

**DRAFT** all rights reserved to  
growplan ltd  
dunedin.nz

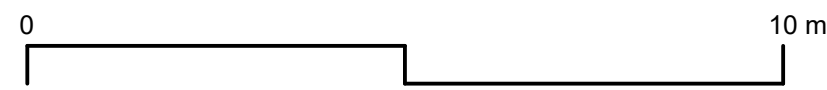

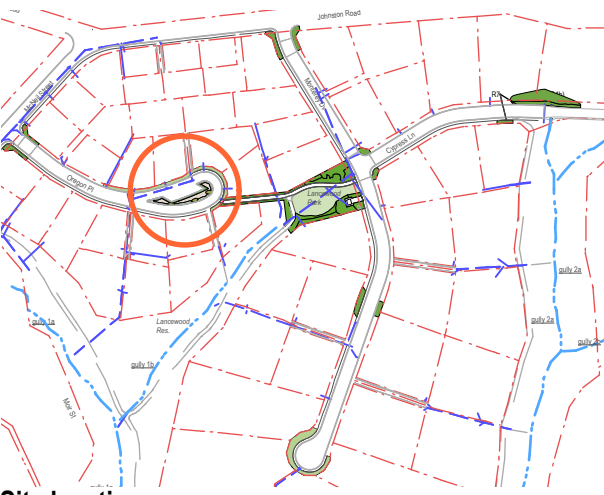

Site location

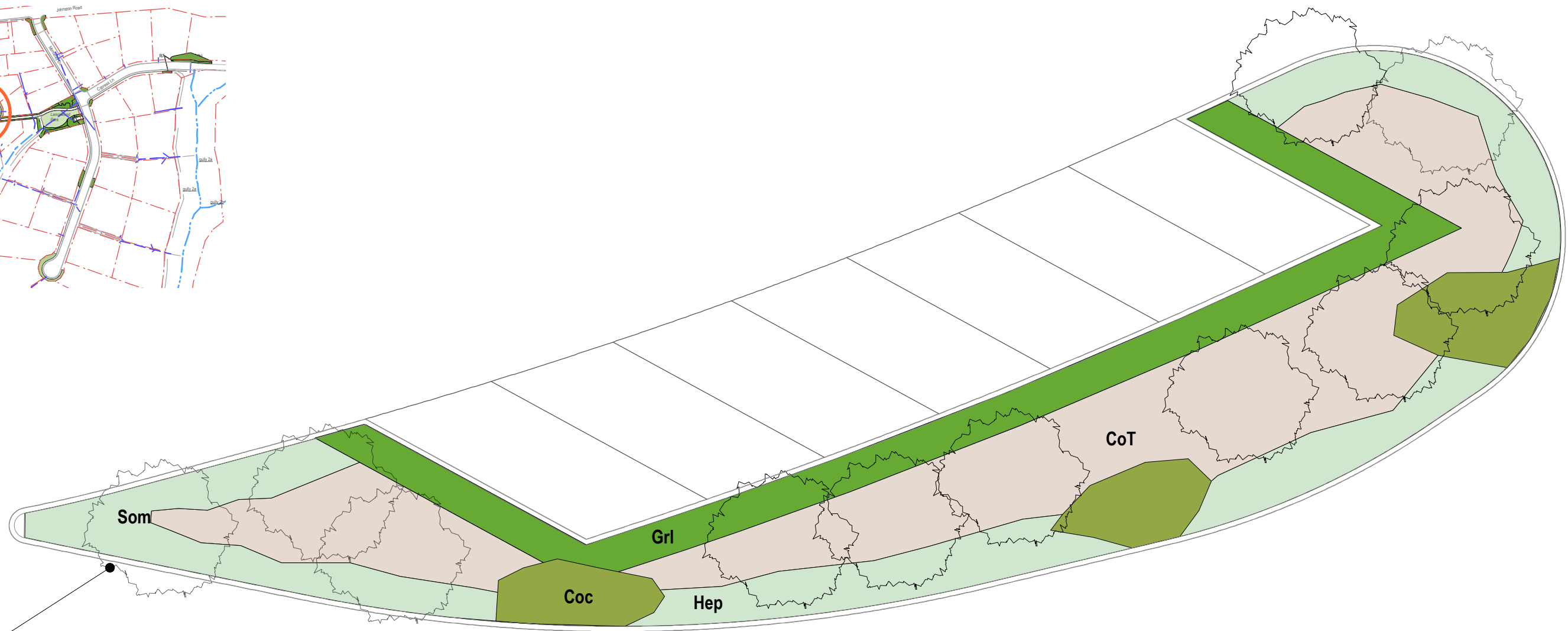

Kowhai trees

2.1d YR1 Road planting - Oregon cul-de-sac				T Area for manual entry
botanical name	common name	code	units	planting note
Coprosma crassifolia	coprosma	Coc	20	Island clumps along south edge
Coprosma Taiko	coprosma	CoT	75	Island edge surround
Hebe pagei prostrata	hebe	Hep	80	Island edge surround
Griselinia littoralis	broadleaf	Grl	39	Island sheltering hedge
Sophora microphylla	kowhai	Som	11	Clumps either end of island
Totals			295	

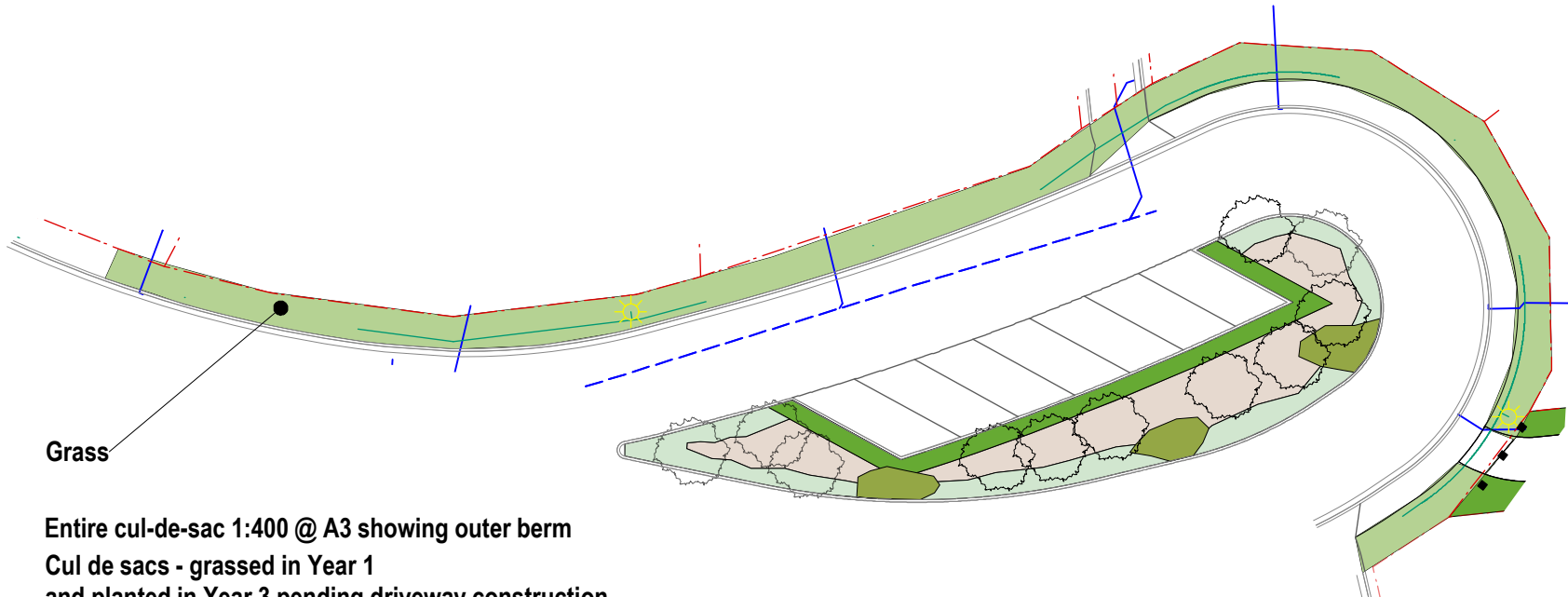

Grass

Entire cul-de-sac 1:400 @ A3 showing outer berm  
 Cul de sacs - grassed in Year 1  
 and planted in Year 3 pending driveway construction

Note light poles -yellow icons- in grass berm

2.1c  
2017.09.20

drawing Details Oregon PI  
 cul-de-sac Planting  
 location Balclutha  
 client Clutha District

scale 1:125 @ A3  
 www.growplan.co.nz  
 nigel@growplan.co.nz  
 027 214 7791

file 125.plantation.v  
 • confirm services  
 • do not scale off plan  
 • verify all dimensions

**DRAFT** all rights reserved to  
 growplan ltd  
 dunedin.nz



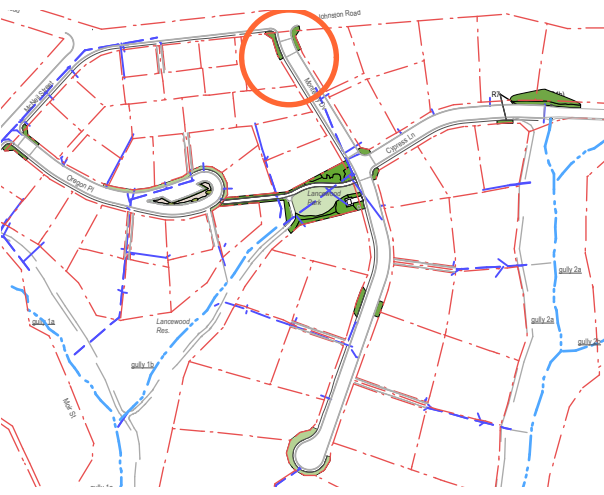

Site location



YR1 Road entry planting - Monterey Drive						
botanical name	common name	code	clump	T units	units	planting note
Coprosma brunnea	brunner's coprosma	Cob			29	Groundcover mass as per codes
Coprosma Taiko	coprosma	CoT			29	Groundcover mass as per codes
Hebe pinguifolia Pagei	hebe	Hep			29	Groundcover mass as per codes
Pinus Mops_Gnome	cvr name	Pim			12	Clumps wrapping signs from ends
Sophora microphylla	kowhai	Som			6	Three each side across rear of panels and to sides
Totals					106	

Table 2.2b Monterey Drive entry plants - planting area 114m2

2.2b  
2017.09.20

drawing Monterey Drive entry planting  
location Balclutha  
client Clutha District

scale 1:100 @ A3  
www.growplan.co.nz  
nigel@growplan.co.nz  
027 214 7791

file 125.plantation.v  
• confirm services  
• do not scale off plan  
• verify all dimensions

**DRAFT** all rights reserved to growplan ltd  
dunedin.nz

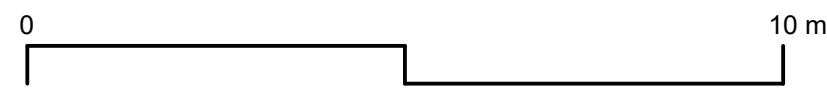

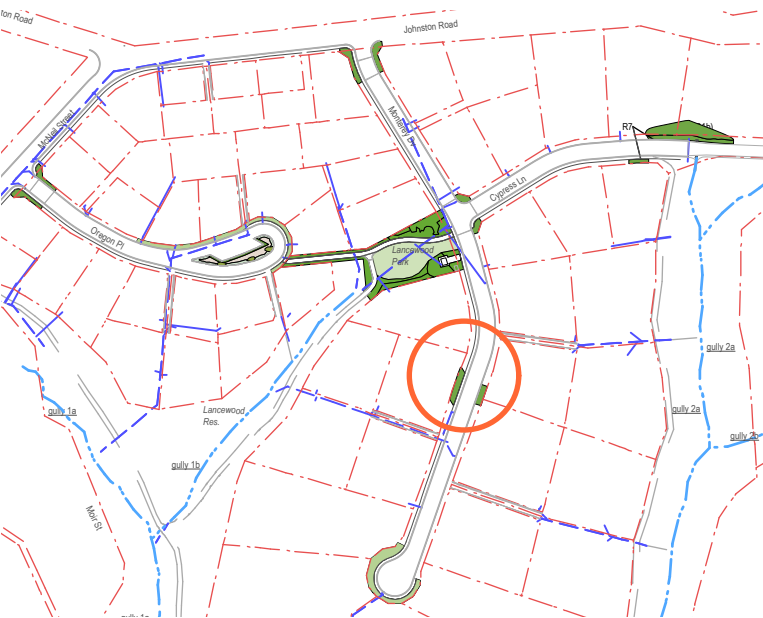

Site location

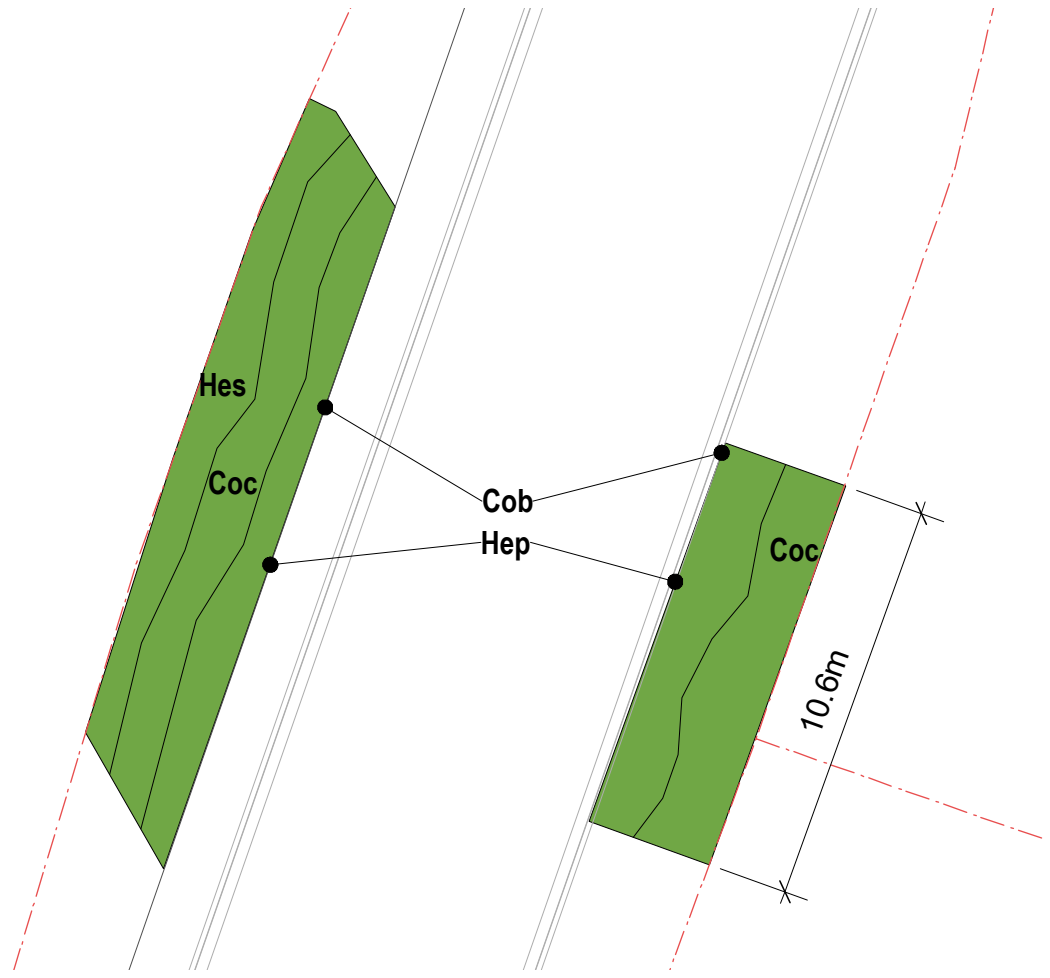

YR1 Road planting - Monterey mid-area				2.2c
botanical name	common name	code	units	planting note
Coprosma brunnea	brunner's coprosma	Cob	25	Centre line to front - groundcover mass 50%
Coprosma crassifolia	coprosma	Coc	15	West side - central wavy shrub band, east to rear
Hebe pagei prostrata	hebe	Hep	25	Centre line to front - groundcover mass 50%
Hebe salicifolia	koromiko	Hes	20	West - set to rear in wavy band
Totals			85	

Table 2.2c Monterey mid-area shrub area - planting area 96m2

**2.2c**  
2017.09.20

drawing **Monterey Drive mid-area planting**  
location **Balclutha**  
client **Clutha District**

scale **1:200 @ A3**  
[www.growplan.co.nz](http://www.growplan.co.nz)  
[nigel@growplan.co.nz](mailto:nigel@growplan.co.nz)  
027 214 7791

file **125.plantation.v**  
• confirm services  
• do not scale off plan  
• verify all dimensions

**DRAFT** all rights reserved to growplan ltd dunedin.nz





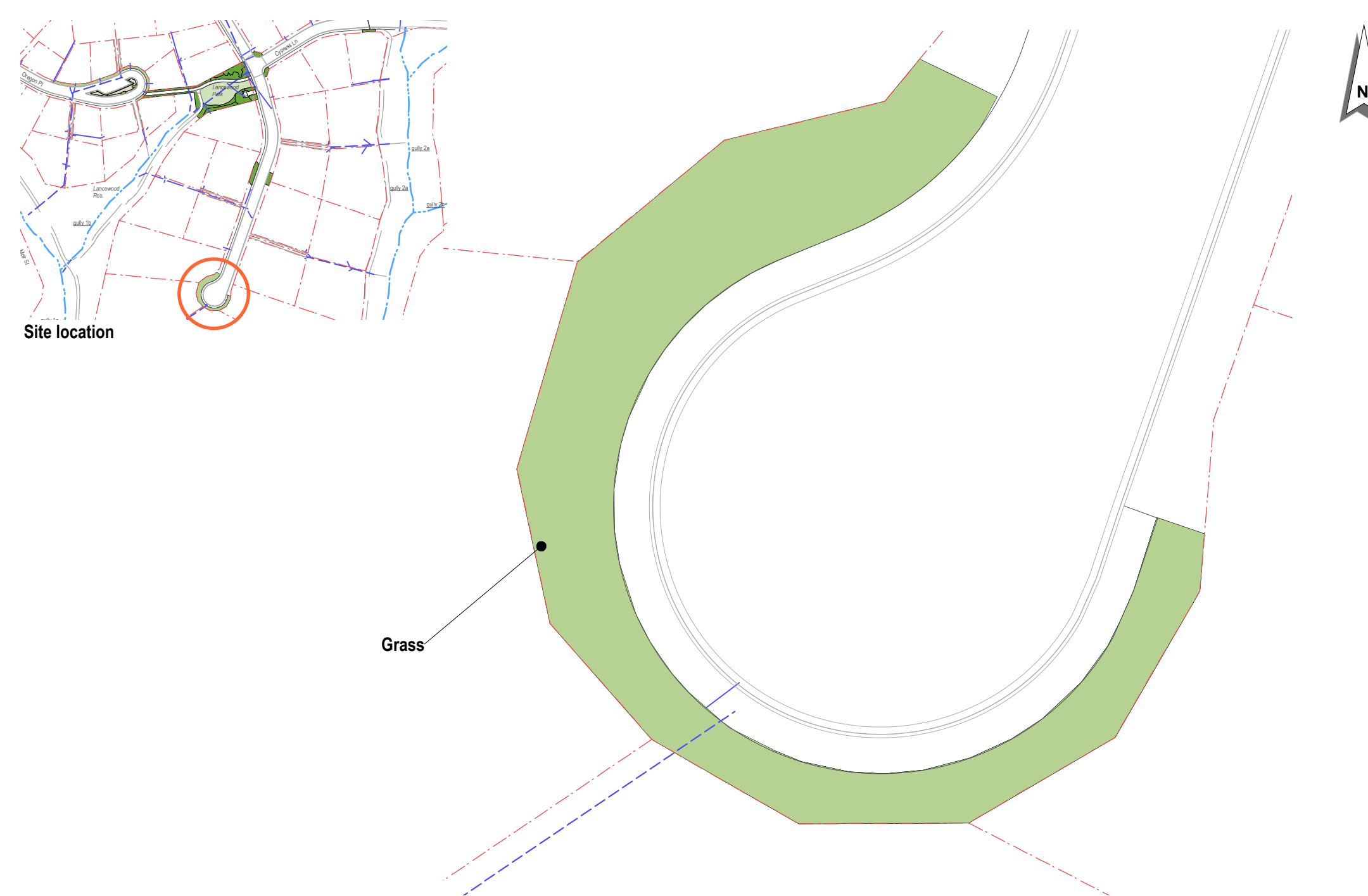

YR1 Road planting - Monterey cul-de-sac		
botanical name	common name	code
Coprosma crassifolia	coprosma	Coc
Coprosma propinqua	coprosma	Coo
Coprosma Taiko	coprosma	CoT
Hebe salicifolia	hebe	Hen
Teucrium parvifolium		Tep
Totals		

Table 2.2d Monterey cul-de-sac shrub area - planting area 196m2

Cul de sacs - grassed in Year 1 and planted in Year 3 pending driveway construction

2.2d  
2017.09.20

drawing Monterey Drive  
location cul-de-sac planting  
client Balclutha  
Clutha District

scale 1:200 @ A3  
www.growplan.co.nz  
nigel@growplan.co.nz  
027 214 7791

file 125.plantation.v  
• confirm services  
• do not scale off plan  
• verify all dimensions

**DRAFT** all rights reserved to  
growplan ltd  
dunedin.nz





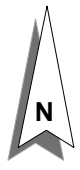

Site location

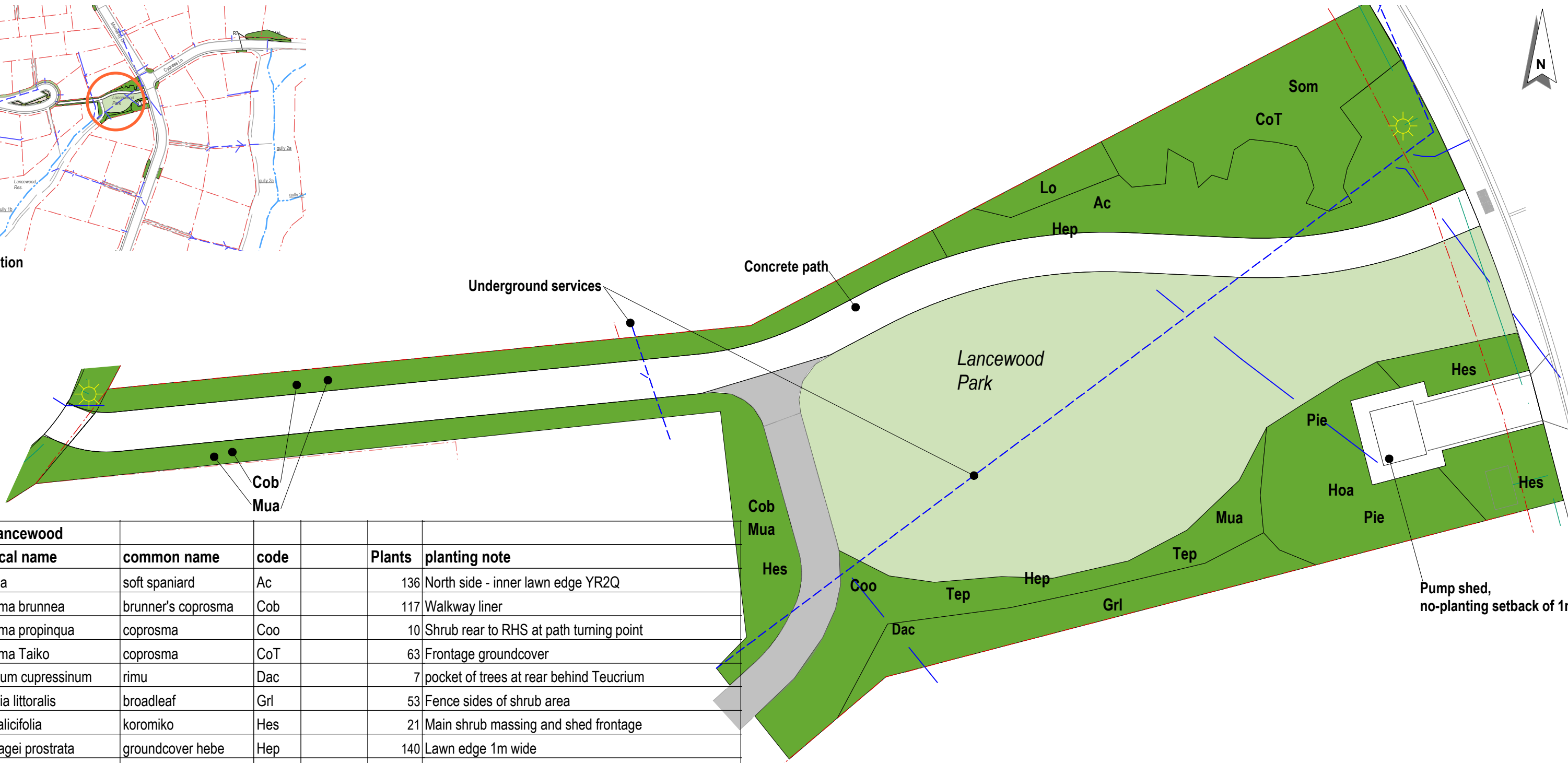

YR1 Lancewood				
botanical name	common name	code	Plants	planting note
Aciphylla	soft spaniard	Ac	136	North side - inner lawn edge YR2Q
Coprosma brunnea	brunner's coprosma	Cob	117	Walkway liner
Coprosma propinqua	coprosma	Coo	10	Shrub rear to RHS at path turning point
Coprosma Taiko	coprosma	CoT	63	Frontage groundcover
Dacrydium cupressinum	rimu	Dac	7	pocket of trees at rear behind Teucrium
Griselinia littoralis	broadleaf	Grl	53	Fence sides of shrub area
Hebe salicifolia	koromiko	Hes	21	Main shrub massing and shed frontage
Hebe pagei prostrata	groundcover hebe	Hep	140	Lawn edge 1m wide
Hoheria angustifolia	narrow lacebark	Hoa	46	Shed backing screening
Lophomyrtus obcordata	lophomyrtus	Lo	12	Shed backing screening
Muehlenbeckia axilaris	Muehlenbeckia	Mua	98	1m wide frontage of plants\
Pittosporum eugenioides	lemonwood	Pie	46	Behind and sides of shed
Sophora microphylla	kowhai	Som	10	Features to frontage RHS and middle rear LHS YR2
Teucrium parvifolium		Tep	98	South lawn shrub mix 50:50 with Coo
Totals			856	

Table 2.2e Planting upper Lancewood Reserve - planting area 738m2

Upper Lancewood Reserve all has a lawn area of 577m2 to sow and establish - seed species mix in specification Section 5.4 Seed mixture

2.2e  
2017.09.20

drawing Monterey Drive  
Lancewood Reserve  
location Balclutha  
client Clutha District

scale 1:250 @ A3  
www.growplan.co.nz  
nigel@growplan.co.nz  
027 214 7791

file 125.plantation.v  
• confirm services  
• do not scale off plan  
• verify all dimensions

**DRAFT** all rights reserved to  
growplan ltd  
dunedin.nz



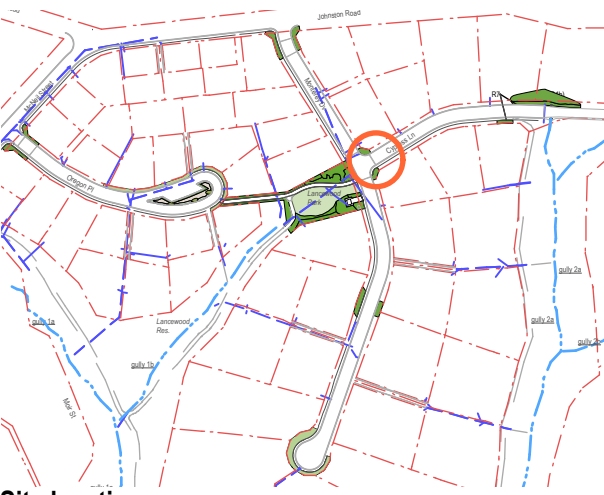

Site location

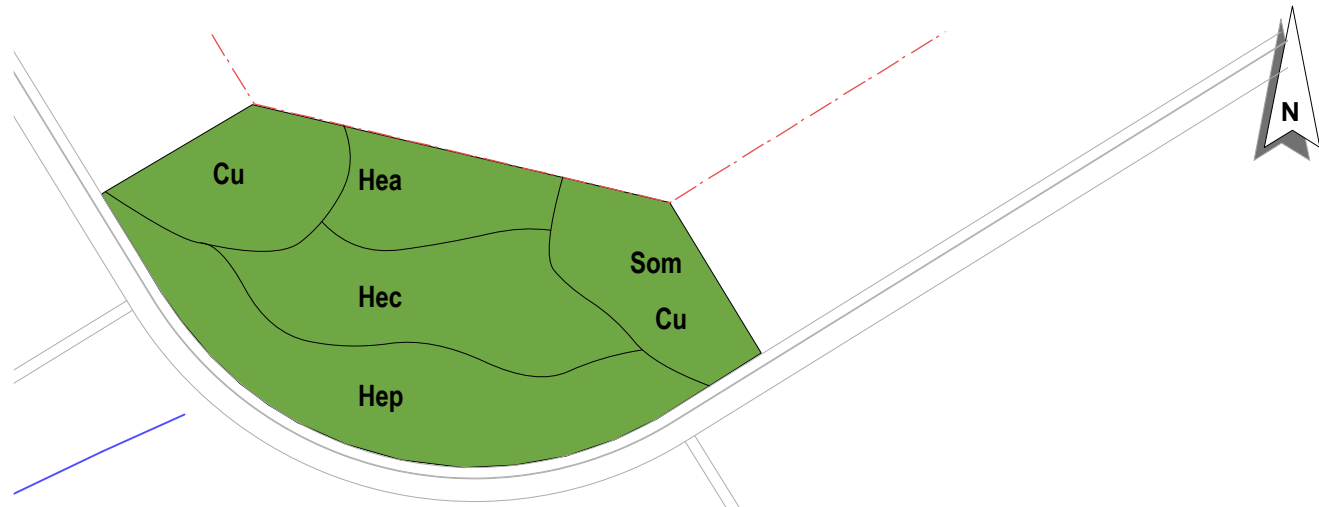

YR1 Road entry planting - Cypress Lane						
botanical name	common name	code	units	units	S17	planting note
Cupressus	low form	Cu	12			Wrapping around both signs from both ends
Hebe albicans	hebe	Hea	10			Wavy band across front of both signs
Hebe chathamica	hebe	Hec	10			In front of Hea
Hebe pagei prostrata	hebe	Hep	10			Remaining area to road and pavement edge
Sophora microphylla	kowhai	Som	8			Two each inner side of road toward rear of bed
Totals			51			

2.3b Cypress entry plants

2.3b  
2017.09.20

drawing Street Planting Plan  
location Cypress Lane  
client Balclutha  
Clutha District

scale 1:100 @ A3  
www.growplan.co.nz  
nigel@growplan.co.nz  
027 214 7791

file 125.plantation.v  
• confirm services  
• do not scale off plan  
• verify all dimensions

**DRAFT** all rights reserved to  
growplan ltd  
dunedin.nz

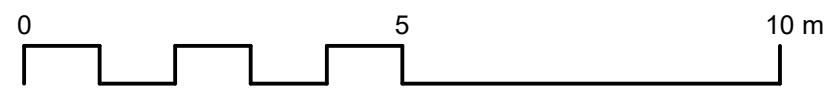

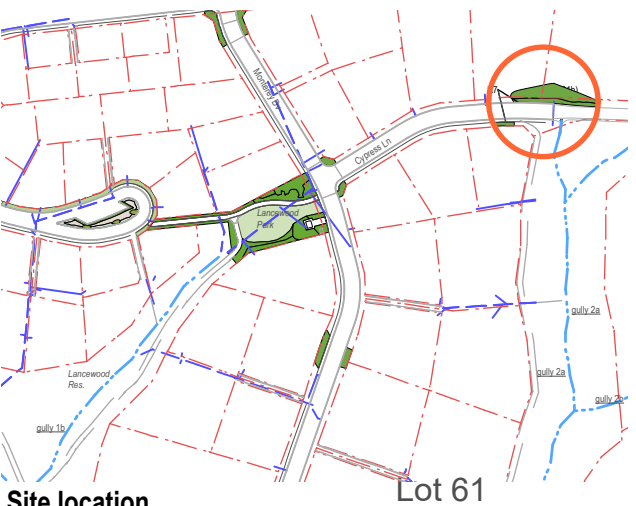

Site location

Lot 61

Lot 60

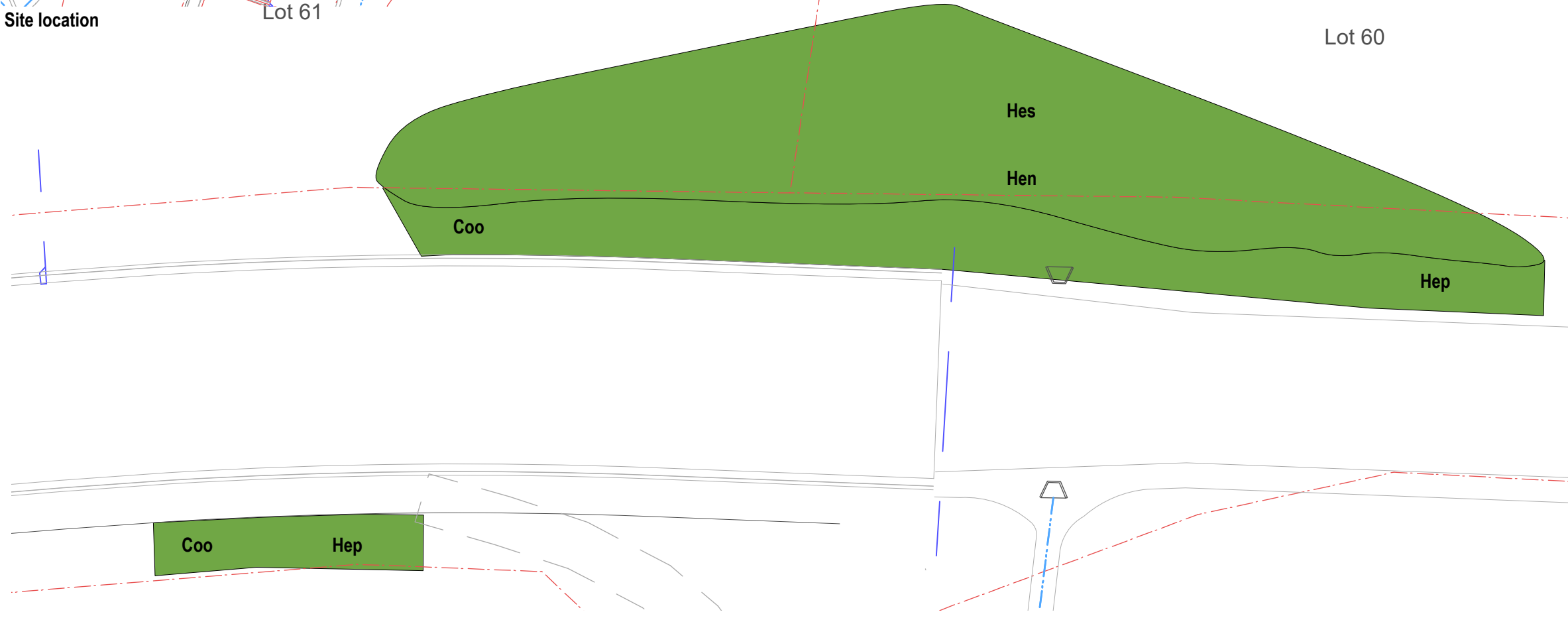

YR1 Road planting - Cypress roadside and berm				T Area for manual entry
botanical name	common name	code	units	planting note
Coprosma propinqua	coprosma	Coo	61	Roadside area random equal spacing
Hebe pagei prostrata	hebe	Hep	45	Roadside random, 800mm from road edge
Hebe salicifolia	koromiko	Hes	123	Bank mass
Hebe Snow_form	hebe	Hen	25	Bank lower edge
Totals			253	

2.3c Cypress entry plants

2.3c  
2017.09.20

drawing Cypress Lane  
location berm and RR planting  
client Balclutha  
Clutha District

scale 1:200 @ A3  
www.growplan.co.nz  
nigel@growplan.co.nz  
027 214 7791

file 125.plantation.v  
• confirm services  
• do not scale off plan  
• verify all dimensions

**DRAFT** all rights reserved to  
growplan ltd  
dunedin.nz

