



**RECORD OF TITLE
UNDER LAND TRANSFER ACT 2017
FREEHOLD
Search Copy**



R. W. Muir
Registrar-General
of Land

Identifier **OT14B/688**
Land Registration District **Otago**
Date Issued 03 February 1992

Prior References

OIC 796160

Estate Fee Simple
Area 1.6900 hectares more or less
Legal Description Section 1-2 Survey Office Plan 23610

Registered Owners

Jennifer Anne Mitchell as to a 1/2 share
Dale Clifford Mitchell as to a 1/2 share

Interests

The bed on the Clutha River and the bed of an unnamed stream are excluded
Subject to Part IV A Conservation Act 1987
Subject to Section 11 Crown Minerals Act 1991
9944846.3 Mortgage to Southland Building Society - 28.1.2015 at 3:14 pm

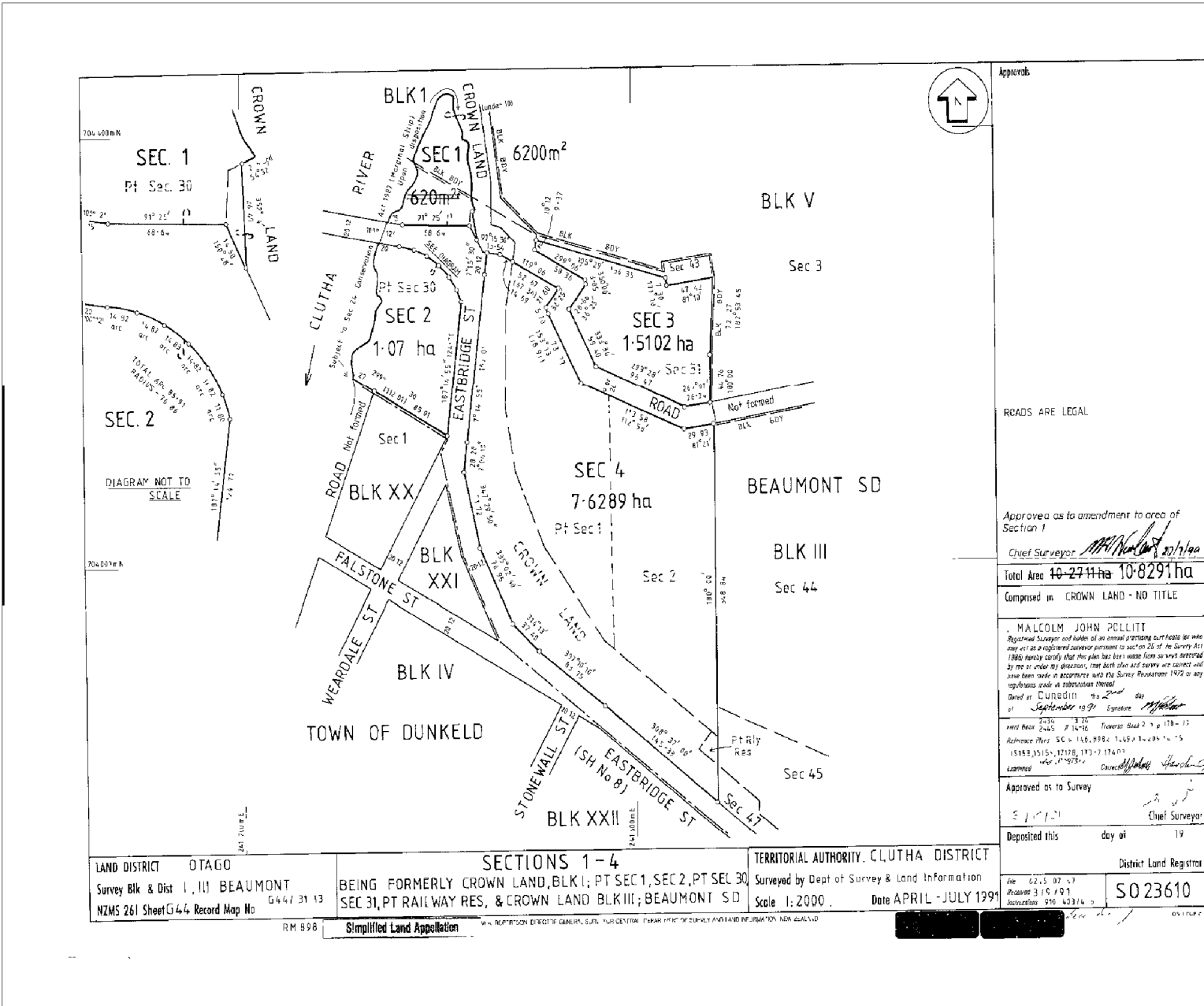

Approvals

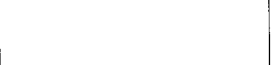

ROADS ARE LEGAL

Approved as to amendment to area of Section 1

Chief Surveyor *[Signature]* 27/1/00

Total Area 10-2711 ha 10-8291 ha

Comprised in CROWN LAND - NO TITLE

MALCOLM JOHN POLLITT
Registered Surveyor and holder of an annual practicing certificate for who may act as a registered surveyor pursuant to section 25 of the Survey Act 1980 hereby certify that this plan has been made from an actual and correct survey made in accordance with the Survey Regulations 1979 or any regulations made in substitution thereof

Dated at Dunedin this 2nd day of September 1997

Witness
I, the Chief Surveyor, do hereby certify that the above is a true and correct copy of the original plan as shown to me or under my direction, and that the survey was conducted and approved in accordance with the Survey Regulations 1979 or any regulations made in substitution thereof

Approved as to Survey

Chief Surveyor

Deposited this day of 19

District Land Registrar

File 623 82 57
Process 319 991
Subsection 210 403/4

SO 23610