

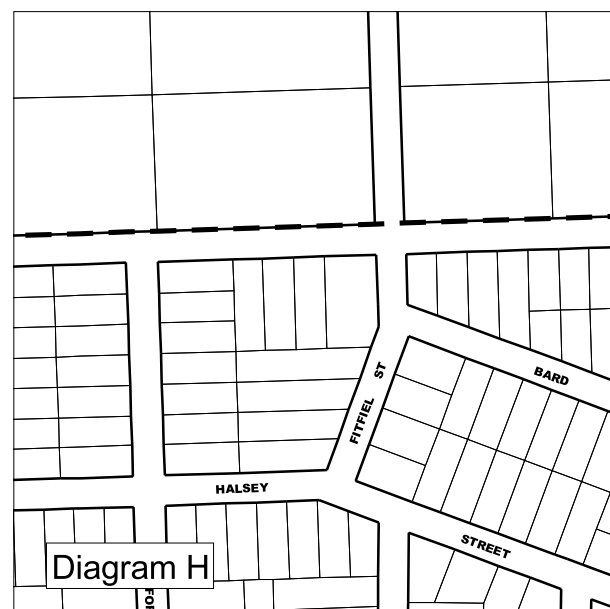

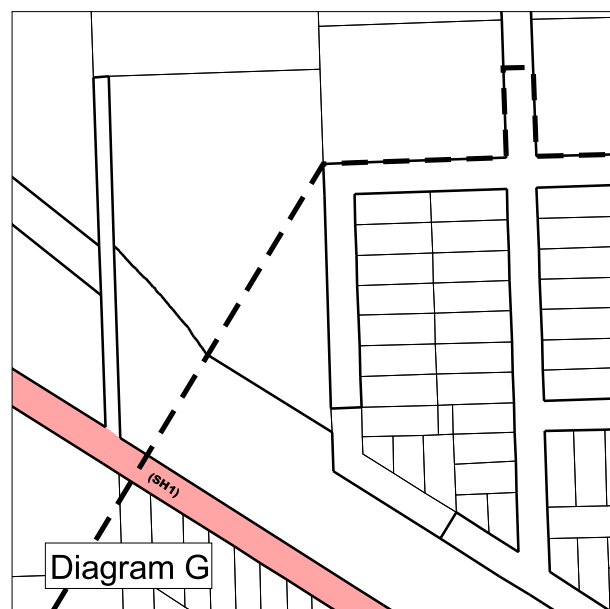
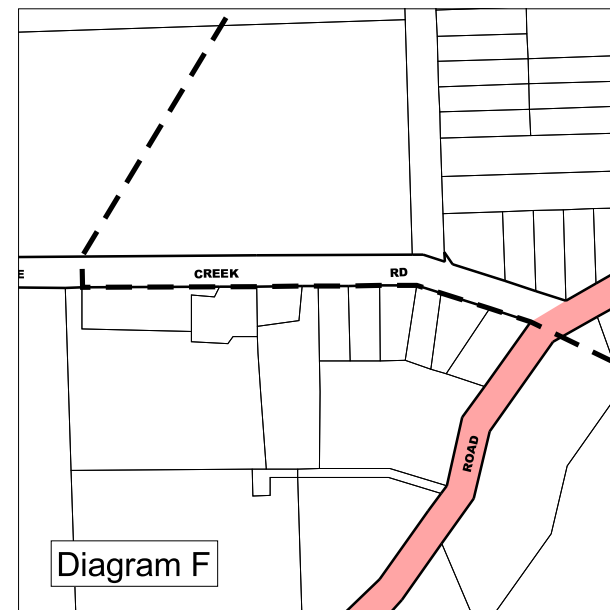
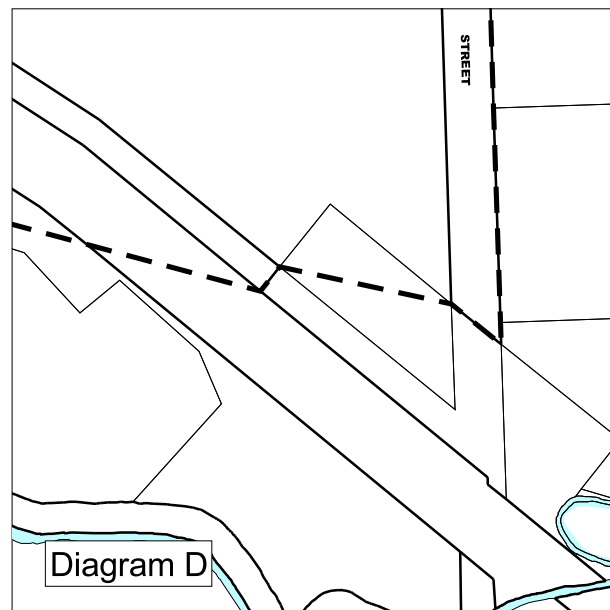
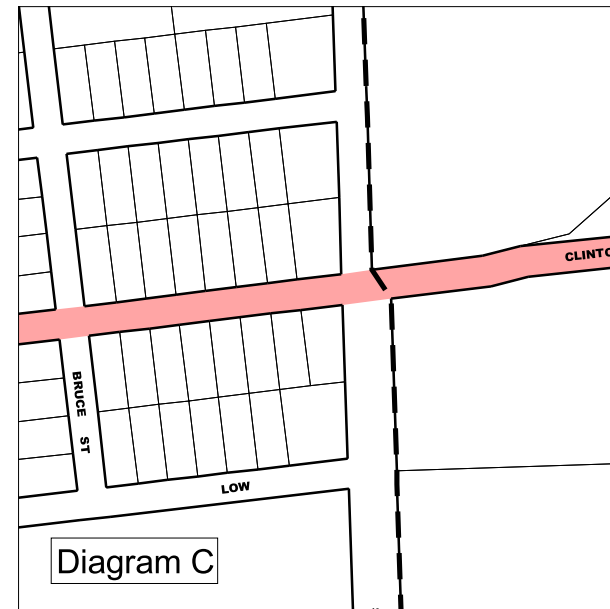
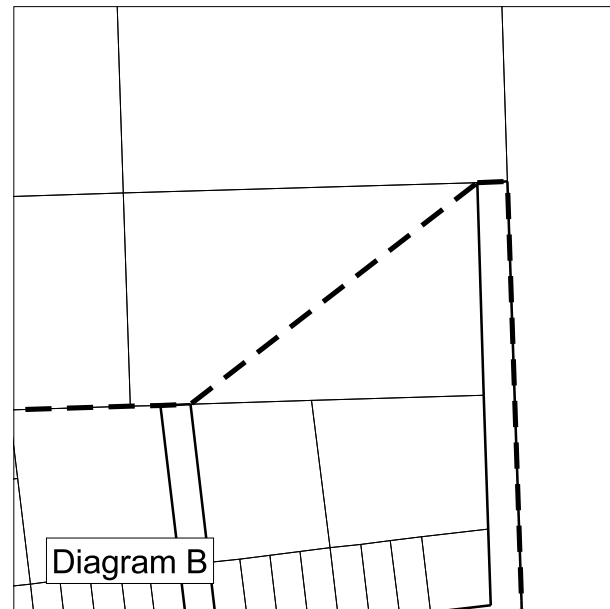
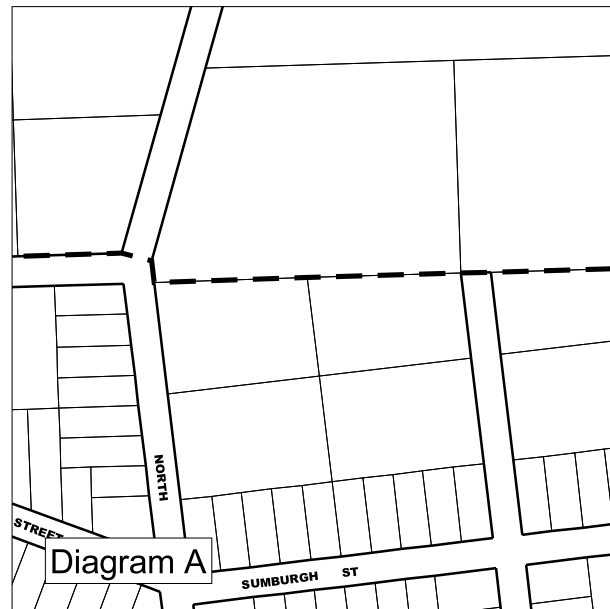

# CLUTHA DISTRICT COUNCIL SPEED LIMITS

(EXCLUDING ALL STATE HIGHWAYS)

## DIAGRAM SHEET

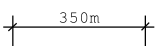

SPEED LIMITS FOR CLUTHA DISTRICT ( EXCLUDING ALL STATE HIGHWAYS)	
<b>LEGEND</b>	
	BOUNDARY OF URBAN TRAFFIC AREA THAT HAS A SPEED LIMIT OF 50km/h
	ROAD RESERVE
	CADASTRAL BOUNDARIES
	STATE HIGHWAYS WHICH ARE EXCLUDED FROM THIS BYLAW
	350m LENGTH IN METRES OF A SPEED LIMIT OR DISTANCE FROM AN INTERSECTING ROAD TO A SPEED LIMIT BOUNDARY
<b>NOTES</b>	
<ol style="list-style-type: none"> <li>SCALE SHOWN ON THIS MAP ARE APPROXIMATE</li> <li>DIMENSIONS SHOW THE BOUNDARIES OF A SPEED LIMIT FOR THE PURPOSES OF THE BYLAW</li> <li>SPEED LIMIT BOUNDARIES THAT CROSS A ROAD DO SO AT RIGHT ANGLES FROM ONE SIDE OF THE ROAD TO THE OTHER UNLESS SHOWN OTHERWISE, BY THE SHORTEST DISTANCE</li> <li>ALL SPEED LIMIT BOUNDARIES MARKED ALONG A ROAD ARE DEEMED TO RUN ALONG THE EDGE OF THE CARRIAGEWAY</li> <li>ALL ROADS SHOWN ON THESE MAPS OUTSIDE AN URBAN TRAFFIC AREA HAVE A SPEED LIMIT OF 100km/h, UNLESS MARKED WITH A DIFFERENT SPEED LIMIT</li> <li>THIS MAP IS PART OF THE CLUTHA DISTRICT COUNCIL ROADING BYLAW 2008</li> <li>REFER ALSO TO SCHEDULES 1-8 IN THE BYLAW</li> </ol>	
APPROVED:	PLAN NO.
_____ Manager, District Assets	<b>CDCSP-6</b>
DATE: _____	Sheet 2 of 2

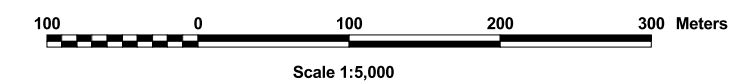

Contains Data Derived from LINZ's DCDB  
Supplied under CDC Digital Licence No. 141228/37  
CROWN COPYRIGHT RESERVED

